



Secondary 2 ECG & Subject Combinations Talk

3 May 2024



Emergency Evacuation

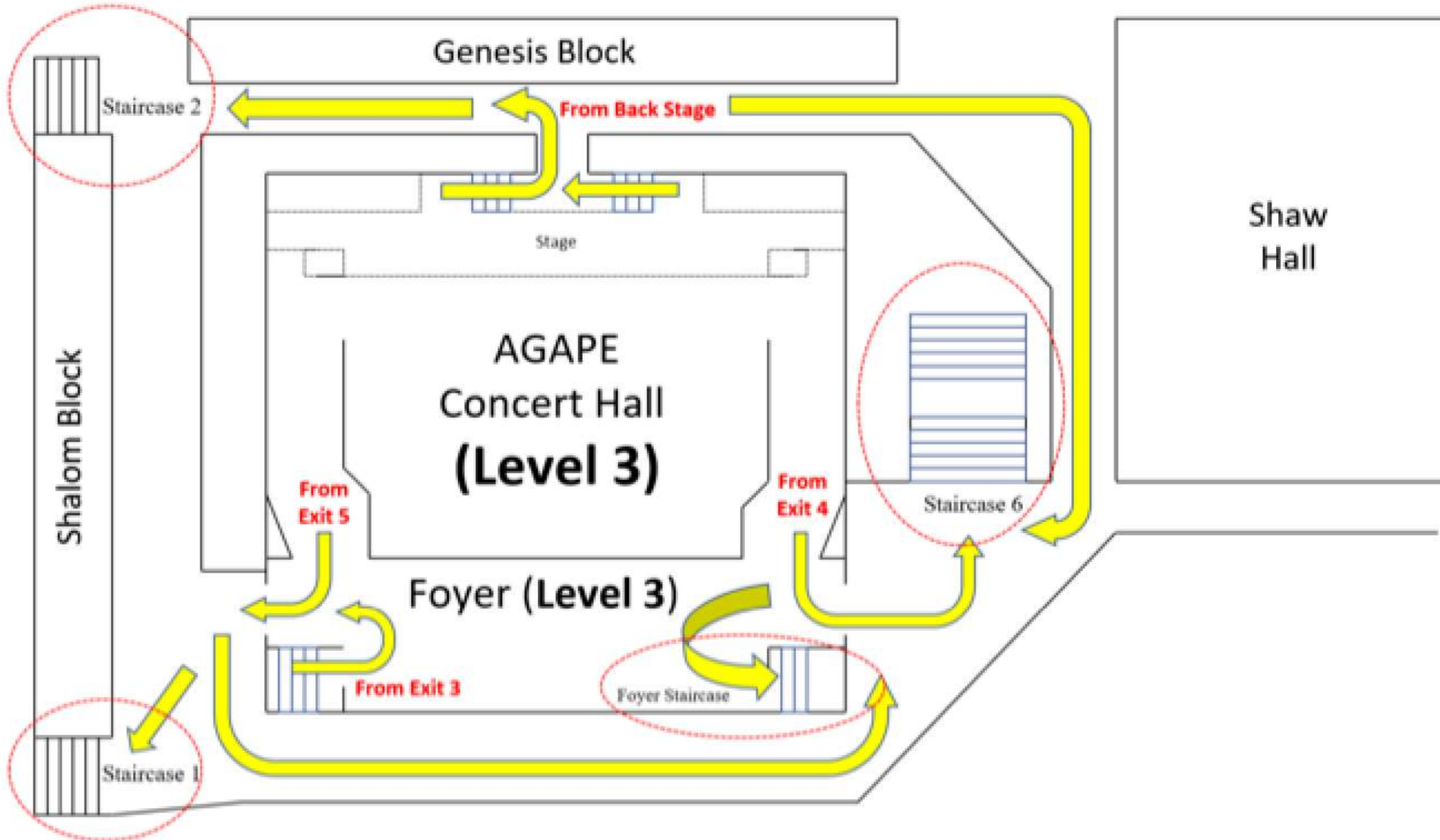

Sec 2 ECG & Subject Combinations Talk Programme Overview

Principal's Address, Ms Amy Ng

Sharing by ECG Counsellor, Ms Priscilla Chong

Question & Answer Segment



(for info) Removed slides on:

- School Leaders and KP photographs – parents can refer to our school website for the information.
- <https://www.plmgss.moe.edu.sg/about-us/our-staff/staff-emails/>



PAYA LEBAR METHODIST GIRLS' SCHOOL (SECONDARY)

CONTENT

1. Our PLMGS Story

- Our 2024 Focus

2. Our Total Curriculum

3. The New Singapore Context – Full SBB

4. Partnering Our Parents

5. 2025 Sec 3 Subject Combinations



PAYA LEBAR METHODIST GIRLS' SCHOOL (SECONDARY)



- No photography
- No videography
- No disclosure / circulation



PAYA LEBAR METHODIST GIRLS' SCHOOL (SECONDARY)

Our PLMGS Story



PAYA LEBAR METHODIST GIRLS' SCHOOL (SECONDARY)

Vision

An outstanding school of choice producing women of fine character with a passion for life and learning

Mission

To nurture every PL-Lite into a whole person who lives in favour of God and man

H.E.A.R.T. Values

- Honour God
- Excellence (Mindset)
- Adaptability
- Respect
- Thankfulness





Level Outcomes

SEC 1
iDiscover

Discover PL and
Build Relationships
with Teachers and
Peers.

SEC 2
iAspire

Aspire to be the Best
Version of Myself

SEC 3
iInfluence

Seek to be a Positive
Influence in Class
and Take
Responsibility for
Own Learning

SEC 4
iInspire

Inspire a Sense of
Hope Through Service
to Others



PAYA LEBAR METHODIST GIRLS' SCHOOL (SECONDARY)

(for info) Removed slides on:

- School Strategy Map
- School Culture definitions

THE PLMGSS CULTURE

CARE

- Value **people** and relationships
- **Empower** people
- Practise **self-care**



EXCELLENCE

- Recognise **effort** and growth - not perfection
- Facilitate **intentional and effective feedback**
- Make **continuous improvement**
- Every experience is a **learning experience**



SCHOOL PRIDE

- **Everyone** can grow and contribute
- **Sense of belonging** to PL and its heritage
- To be a **beacon to the community**





PAYA LEBAR METHODIST GIRLS' SCHOOL (SECONDARY)

2024 Theme & Directions



PAYA LEBAR METHODIST GIRLS' SCHOOL (SECONDARY)



- 2024 Year Theme -

Be True, Pure, Strong and Brave

“

Finally, brothers and sisters, whatever is true, whatever is noble, whatever is right, whatever is pure, whatever is lovely, whatever is admirable — if anything is excellent or praiseworthy — think about such things.

Philippians 4:8

2024 Welcome Gift – Pocket Mirror



- 1. Being a reflection of God – To represent God through our thoughts, our words, and our actions**
- 2. Importance of Self-Reflection – To grow in truth, purity, strength and courage.**





PAYA LEBAR METHODIST GIRLS' SCHOOL (SECONDARY)

2024 School Monthly Themes

MONTHLY THEMES 2024



Jan Be True, Pure, Strong and Brave	Feb Be True to Serve and Shine	Mar Be Pure in Thoughts, Speech and Actions
Apr Be Strong in Overcoming Adversities	May/Jun Be Brave to Step Out in Faith	Jul Be an Example for All
Aug Be a Light to Your World	Sep Be Focused on Our Purpose	Oct Be Thankful!

Decorative dots in the bottom left corner of the grid.



PAYA LEBAR METHODIST GIRLS' SCHOOL (SECONDARY)

Our Total Curriculum



TOTAL CURRICULUM

TOTAL

Curriculum **L**earning content **A**ssessment **P**edagogy **S**taff

Learning Content¹ (Knowledge, Skills, Values or attitudes)

What should my students learn?



Curriculum

How should my students learn?

Pedagogy²

Did my students learn it?

Assessment³

Staff: guided by Singapore Teaching Practice (STP)



Learners Disposition: PEARLS

Total Curriculum					
Curriculum Programme (CP)				Co-curriculum Programme (CCP)	
Languages	Science	Mathematics	CCA	CCE	School-based programmes
Aesthetics	Humanities	PE	Design & Technology		



PAYA LEBAR METHODIST GIRLS' SCHOOL (SECONDARY)

Purpose of Schooling



- 2024 Year Theme -
Be True, Pure, Strong and Brave

“
Finally, brothers and sisters, whatever is true, whatever is noble, whatever is right, whatever is pure, whatever is lovely, whatever is admirable — if anything is excellent or praiseworthy — think about such things.
”

Philippians 4:8

About Ministry of Education, Singapore

The Education Service's Mission is to
mould the future of the nation.



MOE's vision:

"Thinking Schools, Learning Nation"

Research shows:

- **Profession**
- **Performance**
- **Progression**
- **Person**
- **People**
- **Passion**



**CULTURE IS A PROCESS.
A STRONG CULTURE IS BUILT UPON
GOOD **HABITS & ROUTINES.****

Building Good Habits through EFFECTIVE ROUTINES

Building Good Habits through EFFECTIVE ROUTINES

PEARLS (for Pupils)



All teachers (FTs & Subject teachers) will co-construct expectations & consequences with students.

Blended Learning Routines

Regular classroom routines with the use of PLD



C

Charge PLD Fully

- Charge your PLD fully before coming to school
- Be ready with your PLD at the start of lesson



H

Highlight issues to Peers, Teachers or ICT Support Team

- Seek help from peers
- Ask teachers if assistance is needed
- Approach ICT Support Team to troubleshoot technical issues



A

Alert in Safeguarding PLD & School Materials

- Do not leave your PLD unattended
- Protect PLD via Device Care Management
- Use a I-bag system to place PLD & all lesson materials



M

Manage Wi-Fi, Email & Online Lessons

- Check that your Wi-Fi is turned on and check your email regularly
- Actively learn and be self-directed
- Access online lessons & complete them promptly



P

Protect Password

- Remember your password and keep it safe
- If you forgot your MIMS Password, reset it on <https://mims.moe.edu.sg>



S

Screen Down Fully & Listen to Instructions

- Place your screen down fully when teacher is giving instructions



Building Good Habits through EFFECTIVE ROUTINES

3 Stage Reflection Cycle

Adapted from the Gibbs Reflective Cycle

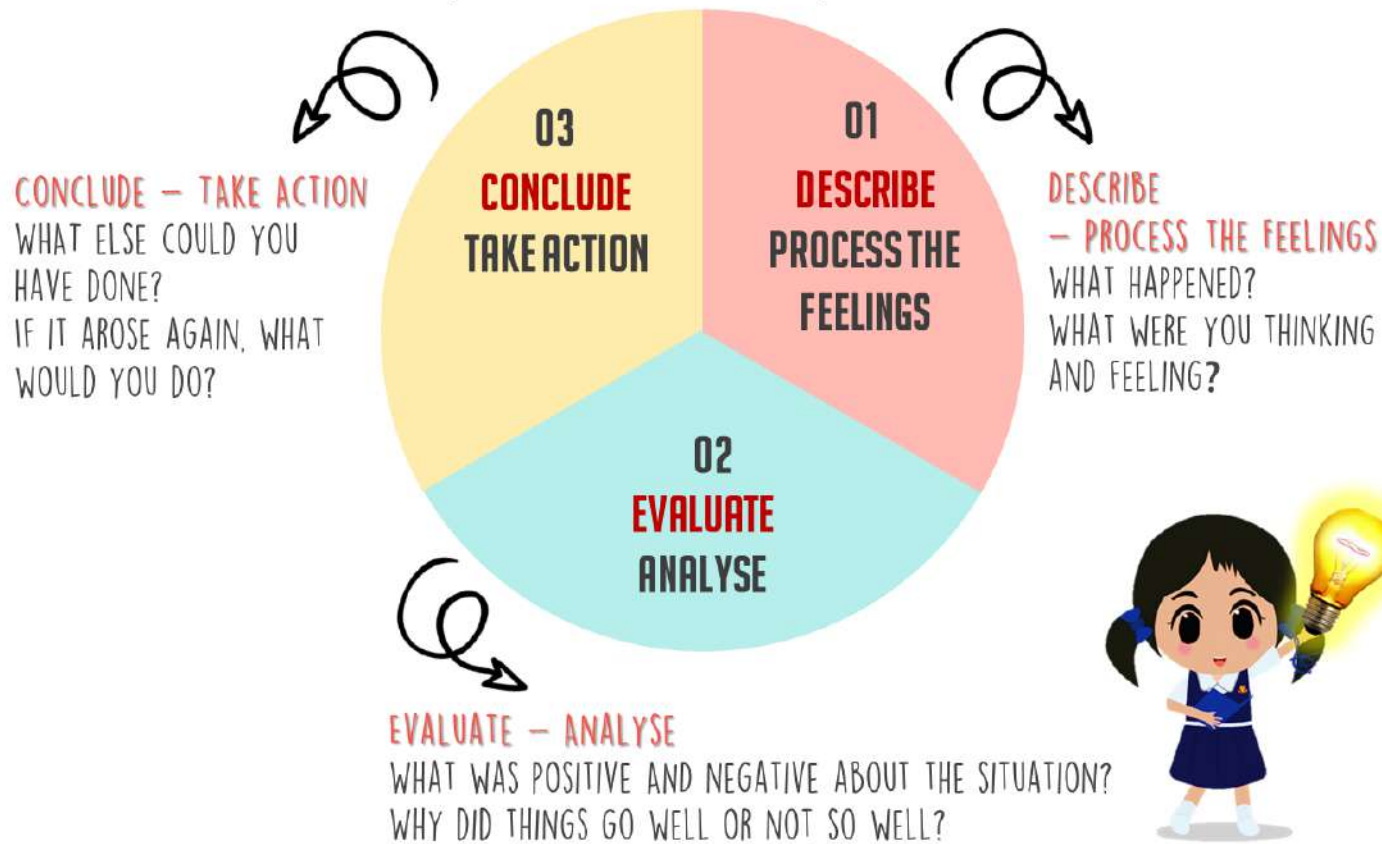

**Reflection Routine:
Making sense of the
lessons, SDEs and other
school experiences in a
meaningful way.**

Building Good Habits through EFFECTIVE ROUTINES

Mighty Ruth's POSITIVE SELF TALK

Be Strong Focus Succeed



I CAN 'GROW' MY BRAIN

Our brains are like our muscles. The **more** we use them, the **better** and stronger our brain gets. We believe we can all learn and achieve.

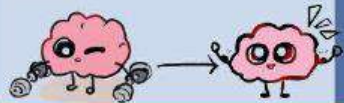

I CAN LEARN FROM MY MISTAKES

Mistakes are opportunities for us to learn. We can identify and acknowledge our weaknesses and emotions. We can listen to feedback and work on improving. We can plan for follow up actions after reflecting from our experiences.



I CAN'T YET!

If we cannot achieve now, it does not mean it is permanent. We can set goals and take steps to **improve** ourselves.

THE POWER OF
YET!



I CAN RISE UP TO A CHALLENGE

We see new experiences as **CHALLENGES** and they are **OPPORTUNITIES** to learn and grow.



We persevere during challenges and pursue our own personal excellence.

I AM NOT ALONE!

We can **ask for help** and get support from family and friends. We can learn **better and achieve more** when we have help.



Write a goal which will bring you closer to your Best Possible Self.

Use the MR Positive Self Talk to overcome the possible obstacles.

Possible Obstacles

Positive Self Talk Responses

Positive Self Talk
Routines to build a
GROWTH MINDSET.

Building Good Habits through EFFECTIVE ROUTINES

**A Common Identity/Vision for the Class
to work towards.**

Illuminators

POSITIVE VIBES, EMBRACE DIVERSITY,
ADAPTABILITY

2024 - 2026

CREDITS: CANVA.COM

**1 WORD which encapsulates your
CLASS VISION + VALUES**

Passionate about CCAs, motivated to study

REPORT: LIM YUFAN
limyufan@sph.com.sg

YOU can pursue your passion and still get good grades.

Abigail Lim, Alison Han and Karthigha Pon Rajoo, who are student leaders at Paya Lebar Methodist Girls' School (Secondary), are living examples.

The 16-year-olds topped the school in the O-level exams, despite being heavily involved in co-curricular activities (CCAs).

Abigail, who is her school's top scorer with eight A1s, is a prefect and the vice-president of the harp ensemble. She is also the student in charge of Campus ChangeMakers, a student body that organises community service projects for the less privileged.

"I'm very happy to have joined the harp ensemble because through it, I've learnt a new skill," said Abigail. "Music is a form of

Ms Annabella Ong, Abigail's English Language teacher, said she had displayed strong leadership qualities, organising meetings among Campus ChangeMakers on her own and delegating work with minimal input from the teachers.

Madam Connie Ng, Abigail's mother, believes that the reason behind her good results is constant revision.

Self-motivated

"I do not push her because she is very self-motivated," said Madam Ng, who is a childcare teacher. "She doesn't study past 11 pm and relaxes by playing the piano whenever she feels stressed."

Alison and Karthigha, who have eight and seven A1s respectively, are two of the other top scorers from the school.

Together with Abigail, Alison was awarded the Colours Award by the school, in recognition of their consistent leadership ability.



HIGH-FLIERS: (From left) Paya Lebar Methodist Girls' School (Secondary) students Karthigha Pon Rajoo, Abigail Lim and Alison Han.
TNP PICTURE: GARY GON

their CCAs.

Alison, the vice-president of the English Literary, Drama and Debating Society, has acted in many of the school's plays and musicals.

Alison said she always looks forward to going for the society as she loves to act and is happy to be with her friends.

"I feel like it is normal for me to act," said Alison, who is also a member of the Prefectorial Board's executive committee. "It is through acting that I express myself better."

As for Karthigha, she has shown eloquence by winning Sorkalam, a national Tamil debate competition, in 2010.

"Through taking part in oratorical competitions, I've gained a lot of confidence in myself," said Karthigha. "It has also helped me in my Tamil, for which I got an A1."

Karthigha, who also has a love of photography, has entered photography competitions as a member of the school's Media and IT Club.

All three girls intend to enrol in junior colleges as they want to keep their options open.

Holistic Education in PLMGS



LEAPS 2.0 points

LEAPS 2.0 is a framework to recognise secondary school students' holistic development.

Students will be recognised with levels of attainment in four domains:

- **L**eadership,
- **A**chievement,
- **P**articipation and
- **S**ervice



PAYA LEBAR METHODIST GIRLS' SCHOOL (SECONDARY)

Demonstrating an Excellent Mindset in the Co-curriculum

Leadership

(Level 3) At least a...

- Class Monitor
- Peer Support Leader
- Peer Lite
- Prefect
- LS CCA chairperson / Vice-chairperson
- LS CCA Exco
- US CCA Comm
- LS House Captain/ Vice-Captain
- US House Comm
- UG Sergeant
- Chairperson / Vice chairperson for GLYW project
- Committee member for school-wide events
- NYAA (Silver)



Service

(Level 5) Completed at least 24 hours of service through...

- **Sec 1 & 2 Local FIS**
- **Sec 3 GLYW** (student-initiated VIA project)
- **Sec 4/5 CNY FIS** that impact the community beyond the school

Achievement

(Level 3) Represented school for ...

- **2 years** in local or external events

Participation

(Level 4) Participated in CCA

- **for 4 years with at least 75% attendance for each year**
- Demonstrate exemplary conduct and active contribution (*Demonstrate 'Very Strongly' in most behaviour traits across the 5 HEART values. (*Refer to "Translating Values to Behaviours" in Annex)*)



PAYA LEBAR METHODIST GIRLS' SCHOOL (SECONDARY)

(for info) Removed slides on:

- LEAPS Outcome results



PAYA LEBAR METHODIST GIRLS' SCHOOL (SECONDARY)

Conduct Grade 2024



(for info) Removed slides on:

- Conduct grade
- Please refer to the student handbook page 20

PL JOURNEY

START

JANUARY

START OF YEAR
START RIGHT

Strategise

Adapt

Relationships

Teamwork

PIT
STOP

MAY

MID YEAR
PIT STOP

Refuel

Reflect

Refocus



OCTOBER

END OF YEAR
WRAP UP
CELEBRATION

We

Recharge

Reflect

Affirm & **P**lay



Working towards your best possible self

Goal setting is important to strive towards your best possible self.

Career and academic goals can help you stay motivated in your studies, and chart your progress.

Character goals allow you to grow as a whole person and to have a positive school experience.

Start Right - Target Setting

Your Current Self

Picture yourself currently. Draw or write to describe your Current Self.



Who
I am
today?

Best Possible Self

Picture yourself in the future (end of your Secondary Education), not confined by constraints and where everything turned out good. Draw/write out your Best Possible Self and be as realistic as possible.



Who
I aspire
to be?



Start Right Programme – Geography LTA, HDB & URA LJs

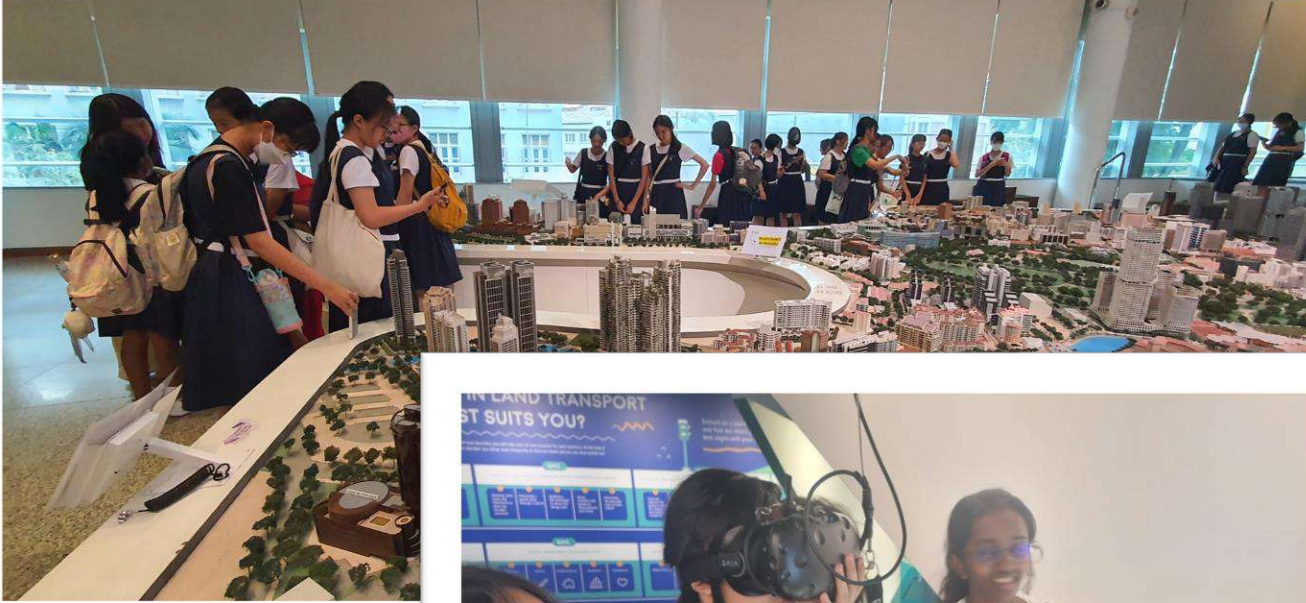

Reinforcing the learning outcomes for Geography Syllabus – Sustainability in Housing & Transport



Start Right Programme – Ngee Ann Poly LJ



**Exposure to e21CC
(Enhance 21st Century
Competencies) skills in
action in preparation for
the students PL21 projects.**



17 MAY – 24 MAY (T2W9 FRI TO T2W1)

SEC 2



SPORTS DAY (FRI 17 May)

Anti-Drug Prevention Talk (MON 20 MAY)

PLSEES
[PL Student Experience & Engagement Survey]

English Programme

Sustainability Experiential Trail LJ

Leadership 201 Workshop

Principal's Dialogue Session
Student Leaders' Dedication Service (FRI 24 May)
Celebrating our PL Staff (FRI 24 May)
Meet-The-Parents (TUE 28 May) via Zoom

**Are you one step
closer to
becoming ...**

**Our Desired
Outcomes of
Education**

Confident students | Passionate Learners

Active Citizens | Inspiring Leaders



PAYA LEBAR METHODIST GIRLS' SCHOOL (SECONDARY)

(for info) Removed slides on:

- Self-Reflection table



PAYA LEBAR METHODIST GIRLS' SCHOOL (SECONDARY)

Instructional Programmes

Assessment in 2024

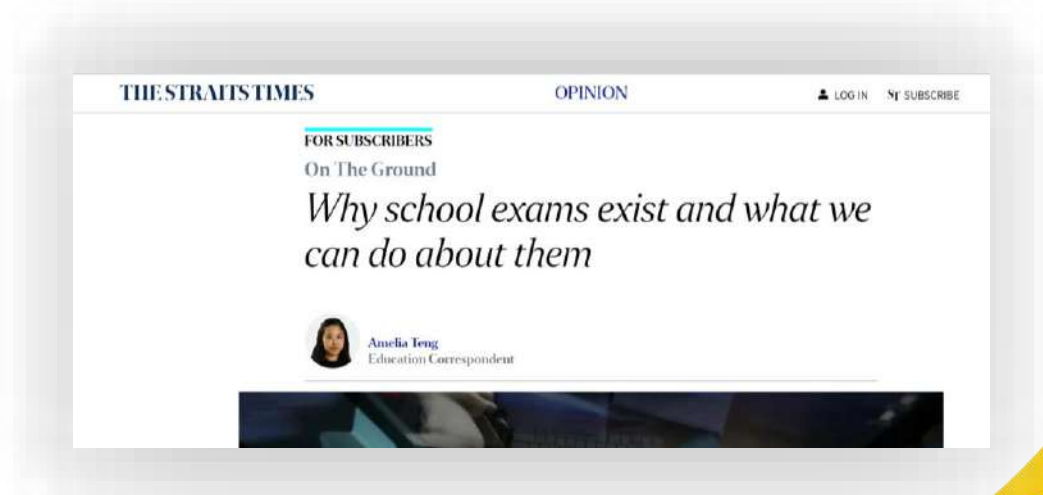
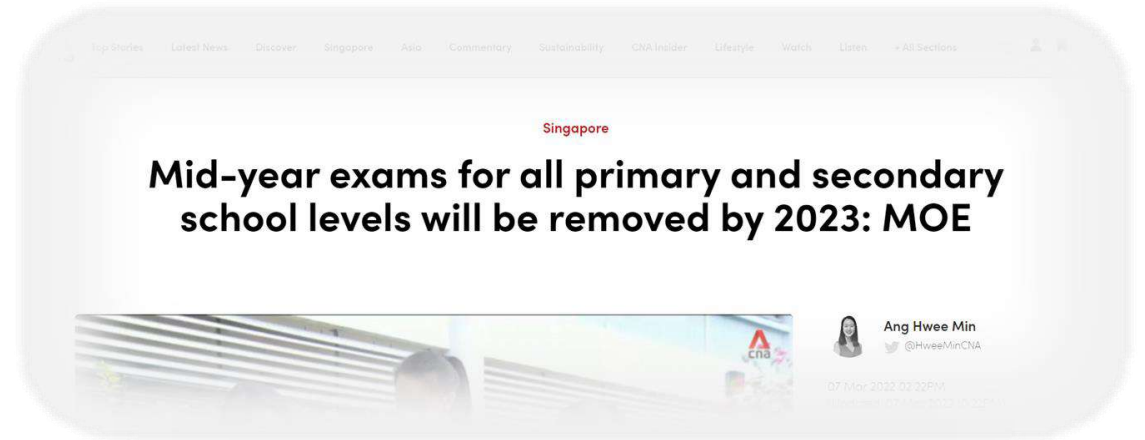



Assessment Plan 2024

Modes of Assessment

- Both formative and summative assessments in the form of class assignments, tests and examinations are planned to enable each student to evaluate and chart progress of her learning in consultation with her teachers.

	Term 1 – Weeks 5-10	Term 2 – Weeks 4-8	Term 3 – Weeks 3-8	Term 4
Sec 1-3	10% - 1 WA through Alternative Assessment or test	15% - 1 WA through Alternative Assessment or test	15% - 1 WA through Alternative Assessment or test	60% - EOY Exam
Sec 4/5	1 WA through Alternative Assessment or test	Timed Practice papers	Prelim Exam	GCE N/O Level Examinations



PAYA LEBAR METHODIST GIRLS' SCHOOL (SECONDARY)

2024 Assessment - FAQs

When will students & parents receive the assessment feedback?

- Students will receive their assessment feedback once the grading is completed. Students will discuss and review the feedback and learning in class with their teachers. Students are encouraged to share their learning and performance with their parents/guardians. Parents/Guardians will receive your daughter/ward's Term 1 Result Slip at the start of Term 2. ***We can share some Term 2 results at the upcoming MTP; result slips will only be available in Term 3.***

What if I am unwell and absent for my assessments?

- For WAs - Should a student be absent on the day of WA, she will need to provide a **valid Medical Certificate***. She will receive the assessment papers for self timed-practice and **'MC'** status will be indicated for the paper. (*Noted that: An MC that is issued by a Chinese Physician and letter of excuse from parent are **INVALID**).
 - NO MAKE-UP TEST will be conducted in the Science Lab
- For Exam - Should a student be absent on the day of exam paper, she will need to provide a **valid Medical Certificate**, a **'MC'** status will be indicated for the paper. A student who is absent from an examination without a MC will get an **'AB'** status (equivalent to zero mark attainment).



(for info) Removed slides on:

- Promotion Criteria (refer to Student handbook page 14)



PAYA LEBAR METHODIST GIRLS' SCHOOL (SECONDARY)

The New Singapore Context

FULL Subject-based Banding (SBB)

WEDNESDAY, SEPTEMBER 4, 2019 | THE STRAITS TIMES

28 secondary schools to pilot full subject-based banding

They will offer humanities at higher level and try out new Sec 1 form class arrangements

Amelia Teng
Education Correspondent

A group of 28 secondary schools will be the first to allow their students to take a greater number of subjects at a higher level next year, ahead of an overhaul to Singapore's education system in a few years.

The Ministry of Education (MOE) yesterday revealed for the first time the 28 schools that will pilot full subject-based banding, where students take subjects, at a higher or lower level, based on their strengths.

The schools include Bedok Green Secondary, Paya Lebar Methodist Girls' School (Secondary), Pei Hwa Secondary and St Patrick's School. Their students will be able to choose to study humanities subjects - geography, history and literature in English - at a more demanding level from Secondary 2, if they have the aptitude. Existing options are English, mathematics, science and mother tongue.

The 28 pilot schools will also try out new Sec 1 form class arrangements instead of the traditional sorting by Express, Normal (Academic) and Normal (Technical) streams. Students from different streams will

be in the same form class and take a common set of subjects that will amount to about a third of curriculum time.

These include art, character and citizenship education, design and technology, and physical education.

MOE said that next year's pilot comes ahead of the roll-out of full subject-based banding to all secondary schools by 2024, in the same year that the Normal and Express streams will be scrapped.

The 28 schools were selected based on their readiness, and all had taken part in earlier phases of subject-based banding and have experience in supporting students of different learning abilities. Teachers have been undergoing training to customise learning to different needs of students, and redesigning resources like assignments or worksheets.

One pilot school, Queenstown Secondary, hopes to let Sec 1 students next year have a hand in naming their classes, besides evenly distributing students from different streams across classes.

Its principal Rasidah Bahim said more students have taken higher-level subjects. On average, about 25 per cent of its Normal (Academic) students take one or more higher-

Bowen Secondary tries out mixed-stream classes for Sec 2 cohort

To prepare for the upcoming changes to form classes, Bowen Secondary School decided to test the waters this year.

It mixed up its Secondary 2 cohort during character and citizenship education (CCE) lessons between March and April as part of a trial to see how students from different streams would take to one another.

Ms Dorothy Lim, senior CCE teacher, said co-curricular activity (CCA) groupings were used as this was already a way for students from all three streams - Express, Normal (Academic) and Normal (Technical) - to mix.

All 280 Sec 2 students took part in five sessions, where they learnt topics such as acceptance and being inclusive. For instance, in learning about empathy with people who have physical disabilities, students refrained from using one limb to play a ball game.

Each of the eight groups had 30 to 35 students from two to three CCAs. They were of different genders, races and academic streams.

They got to make new friends from other CCAs and streams. Sec 2 Express student Huffeza Aziz said: "When you pass the ball during a game, you aren't passing to



Bowen Secondary teacher Alvin Chong facilitating a lesson to help students in a mixed-stream class develop empathy for people who are visually disabled. PHOTO COURTESY OF BOWEN SECONDARY SCHOOL.

an N(A), N(T) or Express student; you are passing it to your friend."

Bowen Secondary is one of the 28 pilot schools implementing full subject-based banding from next year, along with mixed form classes for Sec 1. It usually has seven Sec 1 classes - four Express,

two Normal (Academic) and one Normal (Technical).

Ms Lim hopes students gain a deeper sense of empathy and learn to work with peers who have had different experiences. Next year, the school will also form "buddy groups" for Sec 1

classes to encourage students to look out for one another. Class bonding time - in the form of time for reflection, games or breakfast - will be set aside every Friday too.

Amelia Teng

TOP OF THE NEWS | A5

28 pilot schools

- Ang Mo Kio Secondary
- Assumption English School
- Bedok Green Secondary
- Bowen Secondary
- Clementi Town Secondary
- Deyi Secondary
- Edgefield Secondary
- Evergreen Secondary
- Gan Eng Seng School
- Greendale Secondary
- Jarong Secondary
- Jarong West Secondary
- Mayflower Secondary
- Monfort Secondary
- Paya Lebar Methodist Girls' School (Secondary)

- Pei Hwa Secondary
- Ping Yi Secondary
- Queenstown Secondary
- Riverside Secondary
- St Andrew's Secondary
- St Anthony's Canossian Secondary
- Swiss Cottage Secondary
- Temasek Secondary
- West Spring Secondary
- Whitley Secondary
- Yuying Secondary
- Zhenghua Secondary

that about 10 per cent of its Normal (Academic) students will be able to take humanities subjects at a higher level, while St Andrew's Secondary said about 14 Sec 1 Normal (Academic) students may similarly qualify by the end of this year.

Mrs Marion Tan, principal of St Andrew's, said: "Before we started subject-based banding last year, our lower secondary students took subjects only at the level of their streams. And for many, it was as if they were imposing an artificial cap on how far they should challenge themselves for any subject, even if they had the interest and aptitude for it."

"With subject-based banding, we have students who are willing to push themselves further to realise their potential in a given subject with the help of their teachers. And it often encourages them to excel in other subjects or areas of their school life as well."

ateng@sph.com.sg

PL (Sec) Full SBB Implementation PL is 1 of 28 Pilot Schools.

- 2020 Sec 2 NA/NT - SBB for Humanities in addition to E, M, S, MTL
- 2021 Sec 1 all - Full mix for all S1 classes, common curricular subjects
- 2022 Sec 1 & Sec 2 all - Mixed form classes, common curricular subjects
- 2023 Sec 1 & Sec 2 all - Mixed form classes, common curricular subjects; Sec 3 - mixed form classes based on no. of subjects offered
- 2024 Sec 1 & Sec 2 all - Mixed form classes, common curricular subjects; Sec 3 - retain mixed form class like in Sec 2 = Steady State



From 2024

G3 ~
Express level

G2 ~
N(A) level

G1 ~
N(T) level

Secondary School Experience and Post-Secondary Pathways Under Full SBB

From 2024 Sec 1 cohort onwards, Posting Groups will be used to facilitate the admission of students to secondary schools. Once students are posted to Sec 1, they will have a school experience that better caters to their different strengths, interests, and learning needs, no longer distinguished by academic streams. There will be greater flexibility for students to customise their learning. Students will have more options for their post-secondary pathways, while ensuring they have strong fundamentals, and can thrive in their chosen pathway.

From 2027

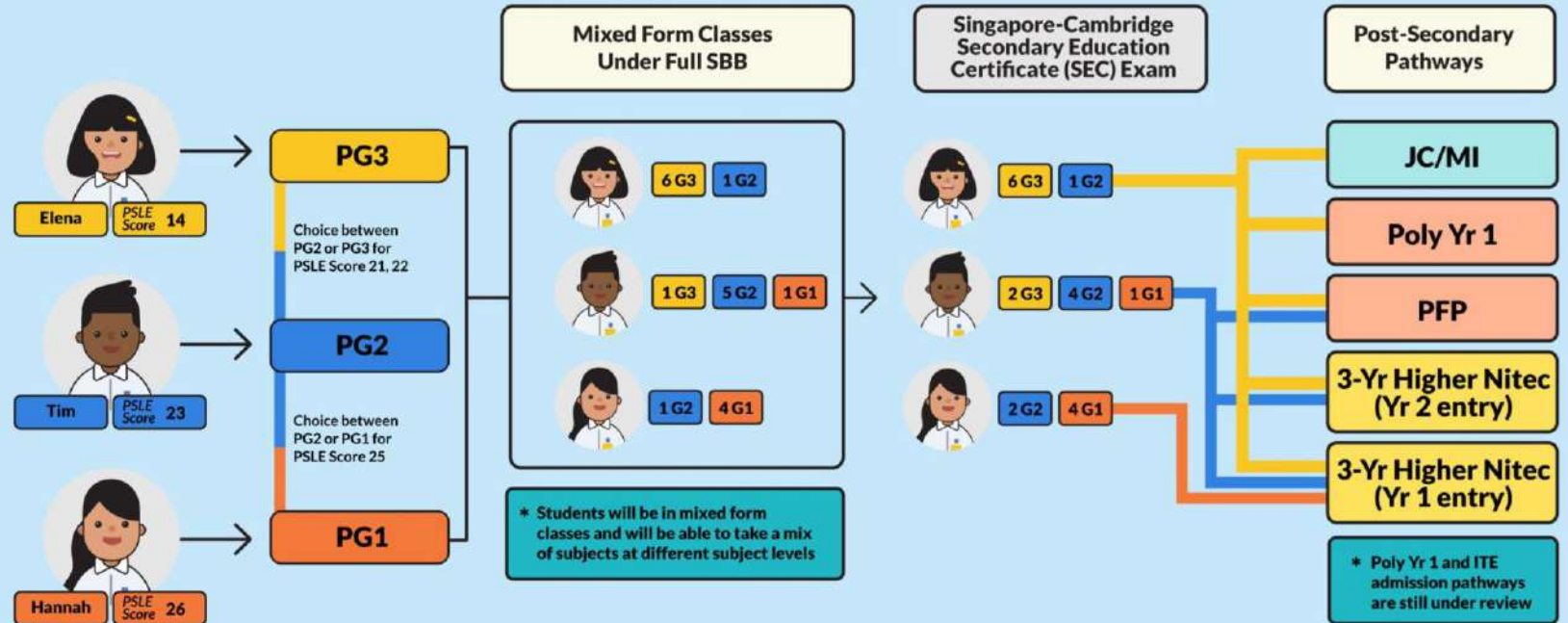



2025 Sec 3 Form Class Structure

Full SBB

- Social-mixing
- Students can offer subjects at APPROPRIATE subject levels

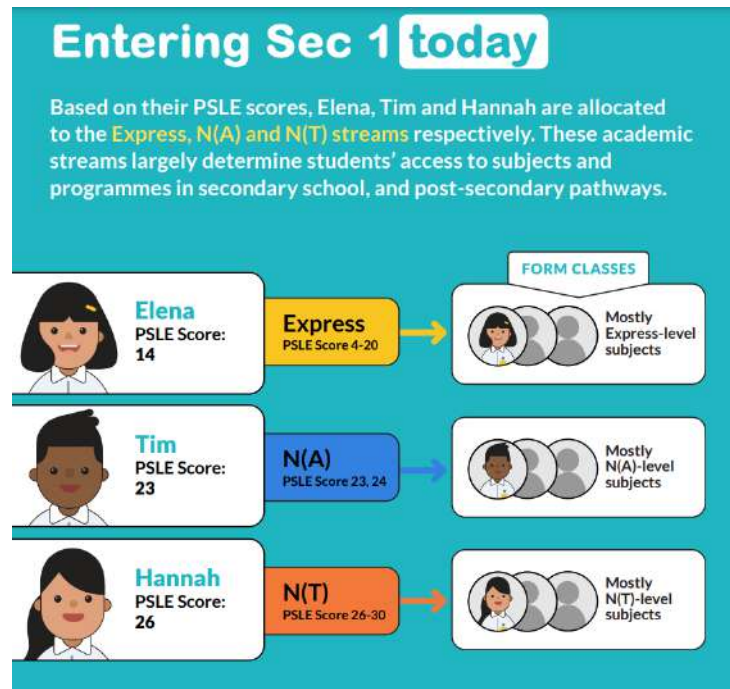

From 2024 Upper Sec Form Class

- Social mixing: similar to Lower Sec – retain current form classes

Class 2024	Class 2025
2.1	3.1
2.2	3.2
2.3	3.3
2.4	3.4
2.5	3.5
2.6	3.6
2.7	3.7
2.8	3.8

Key Considerations:

- Student familiarity with their classmates, needs and aspirations
- Staff needs, strengths, resource availability
- Structure for subject teaching group option formation and generation of timetable



PAYA LEBAR METHODIST GIRLS' SCHOOL (SECONDARY)

Partnering Our Parents



WHY ARE OUR PARENTS HERE TODAY?

School

- What does the school stand for?
- What is in store for my child?

Staff (People)

- Who are the people I will be working with?

Support

- How can I, my family and my child be better equipped for this new journey?





From Sec 1 to Sec 2...

No Change

- **Adolescence (12-18 yrs)**
- **Need Protective Factors**

Changes

- **Physical, Social and Emotional Maturity**
- **Character Growth**
- **Leadership Growth**
- **Starts thinking about future pathways**
- **World around them is changing**

*Desire
for
Personal Agency*



PAYA LEBAR METHODIST GIRLS' SCHOOL (SECONDARY)

From Sec 1 to Sec 2....

1. Help our PL-Lites develop emotional stability

#1: It's natural for teens to become more private and temperamental.

#3: Joining a group can come with social conflicts and bad decisions.

#5: Remind teens that their actions today will affect their future lives as adults.

#2: Teens value being part of a group, and you need to help them avoid the pitfalls of popularity.

#4: You can also help teens understand their strong emotions and pause before reacting



untangled

GUIDING TEENAGE GIRLS
THROUGH THE
SEVEN TRANSITIONS
INTO ADULTHOOD

Lisa Damour, Ph.D.

From Sec 1 to Sec 2...

1. Help our PL-Lites develop emotional stability



Develop a Resilient **MINDSET**



Build Relevant **SKILLS**



Provide a Caring & Enabling **ENVIRONMENT**



From Sec 1 to Sec 2....

2. Help our PL-Lites develop Personal Agency

Personal Agency refers to one's capability to originate and direct actions for given purposes.

PL-Lites with clear goals in mind





2. Help our PL-Lites develop Personal Agency

Promote Consistency of Effort and Goal-Orientation

- *Target-Setting (PL Diary) and Termly Review*
- *Sec 2 Year-end Subject Option Combination*
- *CCAs – NSG/SYF/Other platforms of growth*
- *Faithful-in-Service (FIS)*

Journey with Us!



PAYA LEBAR METHODIST GIRLS' SCHOOL (SECONDARY)

Support for Parents

Share parenting struggles & strategies

- **Fathers@PL**
- **Praying Parents@PL** meets every Monday,
Via Zoom or Face-To-Face





PAYA LEBAR METHODIST GIRLS' SCHOOL (SECONDARY)

Support for Parents

Join
events



**Visit School Website OR Join
PSSSG via**

<https://go.gov.sg/psssgmbrship2024>



PAYA LEBAR METHODIST GIRLS' SCHOOL (SECONDARY)

Keep in touch with the school

Parents' Communications with School

- a) Parents Gateway**
- b) Termly Principal's Letter**
- c) PL Facebook & Instagram**
- d) School Website announcements**
- e) Letters/Consent Forms via Parents Gateway**
- f) Email Comms with Staff and School**



PAYA LEBAR METHODIST GIRLS' SCHOOL (SECONDARY)

Keep in touch with the school

Parents' Communications with School

<https://www.plmgss.moe.edu.sg/articles/guidelines-on-parents-communication-with-the-school>



Within school hours (7.30 a.m. – 6 p.m.), on working weekdays, and during school terms



Teachers are not expected to provide their personal mobile numbers



Urgent messages to teachers may be directed to the school's General Office



Appointments for face-to-face meetings made at least 3 days in advance



Response Time
3-7-21



PAYA LEBAR METHODIST GIRLS' SCHOOL (SECONDARY)

2025 Sec 3 Subject Options and Combinations sharing



(for info) Removed slides on:

- Subject combination and criteria (refer to Subject combination handbook)



What's Running Through my Head....

So how will this impact me?

Will I be in the same teaching group as my current classmates?

I MUST take Subject Combination XXX or I will suffer in the future!

Should I continue to take the Subject at a More Demanding Level, with the latest changes in Curriculum, Assessment & Post-Sec Articulation (in earlier sharing)?



Which path should I take?



- There are **many routes to success**.
- Explore **all possible education options** and look for one that **best fits** your **needs, passion** and **abilities**.
- **It may just mean taking the road less travelled.**



Start Planning for Post-Secondary Education

Admissions Exercises for O-Level Students

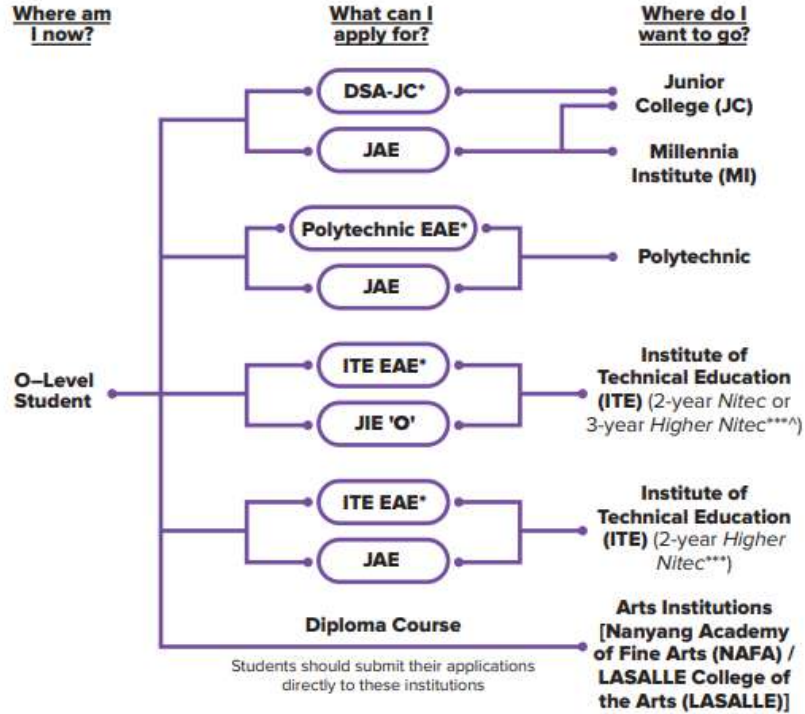

When can I apply?

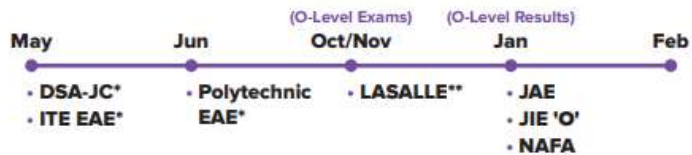

*Students can apply through these admissions exercises before their O-Level examinations
 **Application to LASALLE's diploma programmes starts from September.
 ***Certain Nitec and Higher Nitec courses are available in traineeship mode. For more information on applying to these courses, you can visit <https://www.ite.edu.sg/admissions/traineeship>
 ^There are eight 3-year Higher Nitec courses available for AY2022

Admissions Exercises for N-Level Students

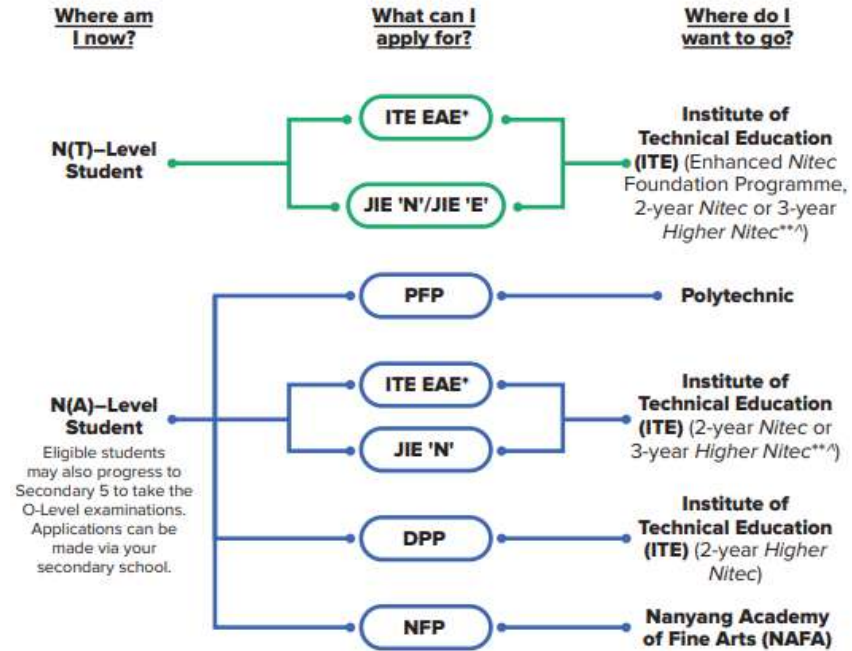

When can I apply?



*Students can apply through these admissions exercises before their examinations.
 **Certain Nitec and Higher Nitec courses are available in traineeship mode. For more information on applying to these courses, you can visit <https://www.ite.edu.sg/admissions/traineeship>
 ^There are eight 3-year Higher Nitec courses available for AY2022



PAYA LEBAR METHODIST GIRLS' SCHOOL (SECONDARY)

Help your daughter develop Personal Agency

Planning for Post-Secondary Education

<https://www.plmgss.moe.edu.sg/article/s/admission-booklets/>

<https://www.myskillsfuture.gov.sg/content/student/en/secondary.html>

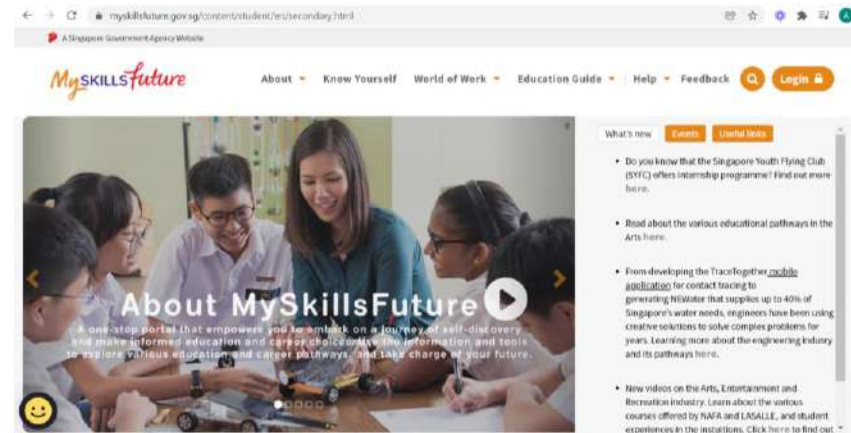
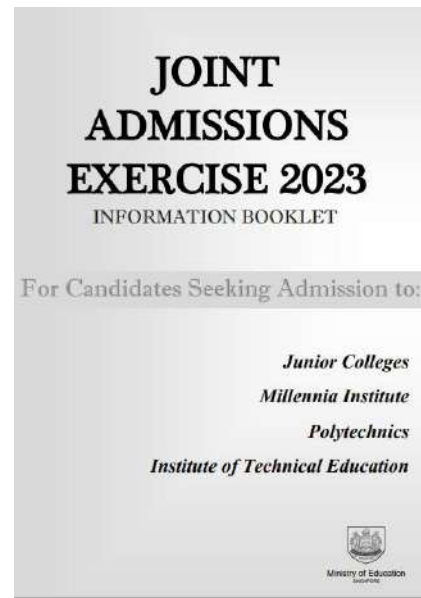
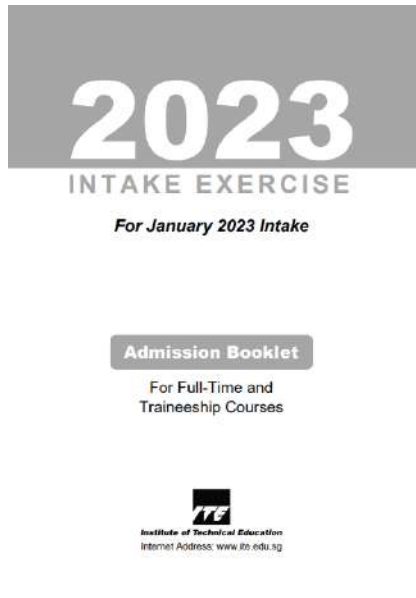

MySKILLSfuture



PAYA LEBAR METHODIST GIRLS' SCHOOL (SECONDARY)

Post-Sec Scholarships

Exp / NA

- MOE Pre-University Scholarship
- Art Elective Scholarship
- MOE Humanities Scholarship
- Language Elective Scholarships
- Music Elective Scholarship
- Regional Studies Programme Scholarship
- DSTA Scholarship
- Cluster Sponsorship - Nursing (Diploma)
- Polytechnic Foundation Programme (PFP) Profession – Nursing
- Sailors' Society - MaritimeONE Scholarship
- BCA-Industry Built Environment Diploma Scholarship / Sponsorship
- Scholarships Offered by Polytechnics
- Scholarships Offered by Lasalle and NaFa

NT

- Community Development Council & Citizen's Consultative Committee-Institute of Technical Education (CDC & CCC-ITE) Scholarship
- BCA-Industry Built Environment ITE Scholarship
- Nursing Sponsorship for NITEC in Nursing
- SingHealth Nursing Sponsorship (NITEC)
- Singapore Olympic Foundation-Peter Lim Sports Scholarship
- Industry Scholarships For ITE Courses

<http://plmgss.moe.edu.sg/instructional-programmes/post-secondary-scholarships>

Unleash Your Potential
MOE Programme-Based and Special Scholarships

Scholarships for:

- Art Elective
- Music Elective
- French Language
- German Language
- Japanese Language
- Spanish Language
- Chinese Language
- English Language
- Malay Language
- Tamil Language
- Humanities
- MOE Pre-University
- Bicultural Studies Programme
- National Elective Tamil Language Programme
- Regional Studies Programme



PAYA LEBAR METHODIST GIRLS' SCHOOL (SECONDARY)

Post-Sec Scholarships Application

Write-up and evidences required

- **JC DSA**
- **Poly/ITE EAE**

1. Candidate's Particulars
2. Academic Achievements
3. CCA Record
4. **School's Assessment of Candidate's Character**
5. **Candidate's Personal Statement**

Accompanying Documents

- GCE 'O' Level Certificate or Results Slip
- CCA Certificate for Secondary[#]
- Character Award Certificate (where applicable)[#]

Conduct, Moral integrity, Care and concern for others, Resilience, Ability to work in teams and Contribution to school/ community/ society



PAYA LEBAR METHODIST GIRLS' SCHOOL (SECONDARY)

(for info) Removed slides on:

- Student results at national examinations



PAYA LEBAR METHODIST GIRLS' SCHOOL (SECONDARY)

Q & A

After ECG Counsellor's Sharing

